

Highbridge Park

Enhance the picturesque park:

Expose gigantic rocks and meadows

Provide more

opportunities for healthy activity:

Improve the recreation center, athletic fields, playgrounds & restrooms

Improve forest and ecology health:

Remove invasive trees and the vines that are killing trees. Enhance habitat for birds and locally rare species such as Dusky Salamanders

Create opportunities for adventure:

Provide rock climbing, mountain biking, skateboarding, and BMX biking

Improve bike path continuity and connections to the community:

Construct a visible and continuous middle level path through the entire length of the park connecting to the High bridge



Highbridge Park

The rocks are cloaked in bittersweet and invasive trees, hiding their great beauty, they are sometimes gigantic, always scenic, and beckon exploration

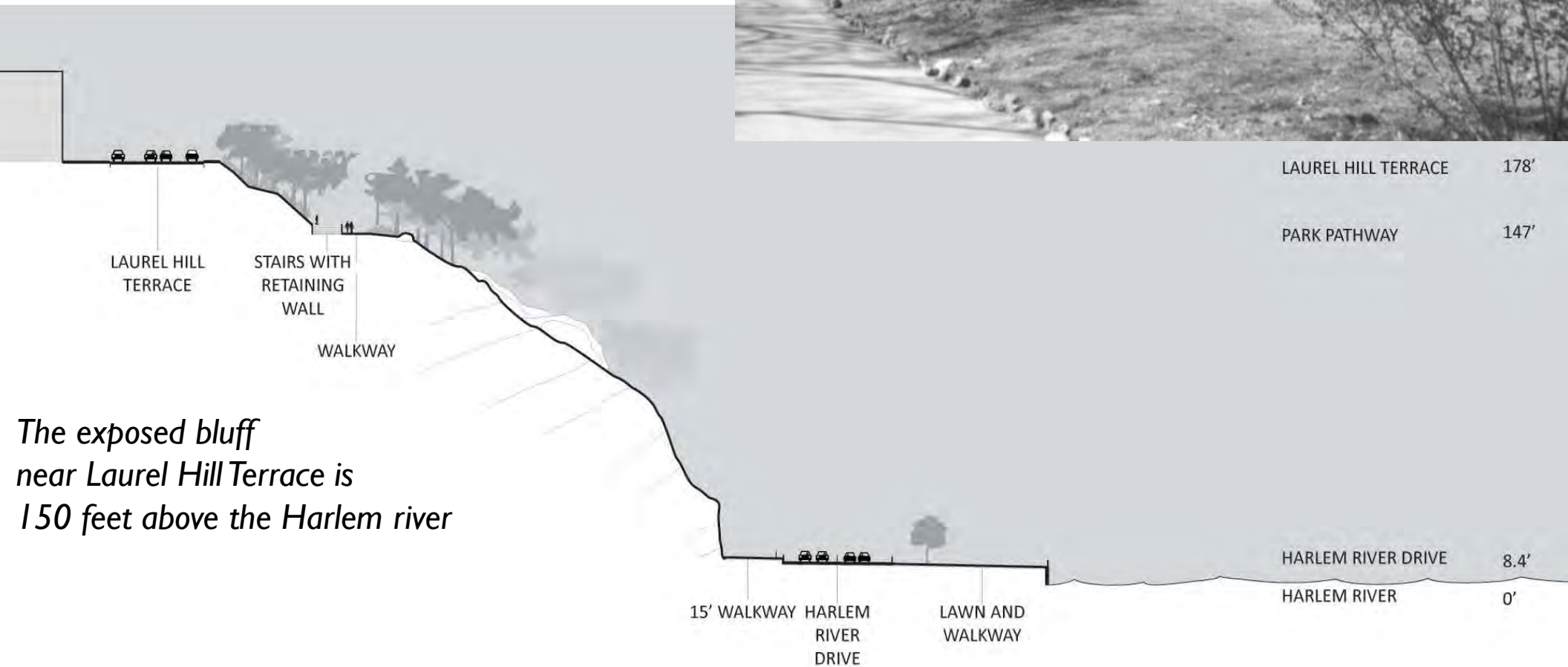

The exposed bluff near Laurel Hill Terrace is 150 feet above the Harlem river

Highbridge Park

The restoration of the High Bridge will make it possible to bike on the **Croton Aqueduct Trail** from Manhattan to Westchester

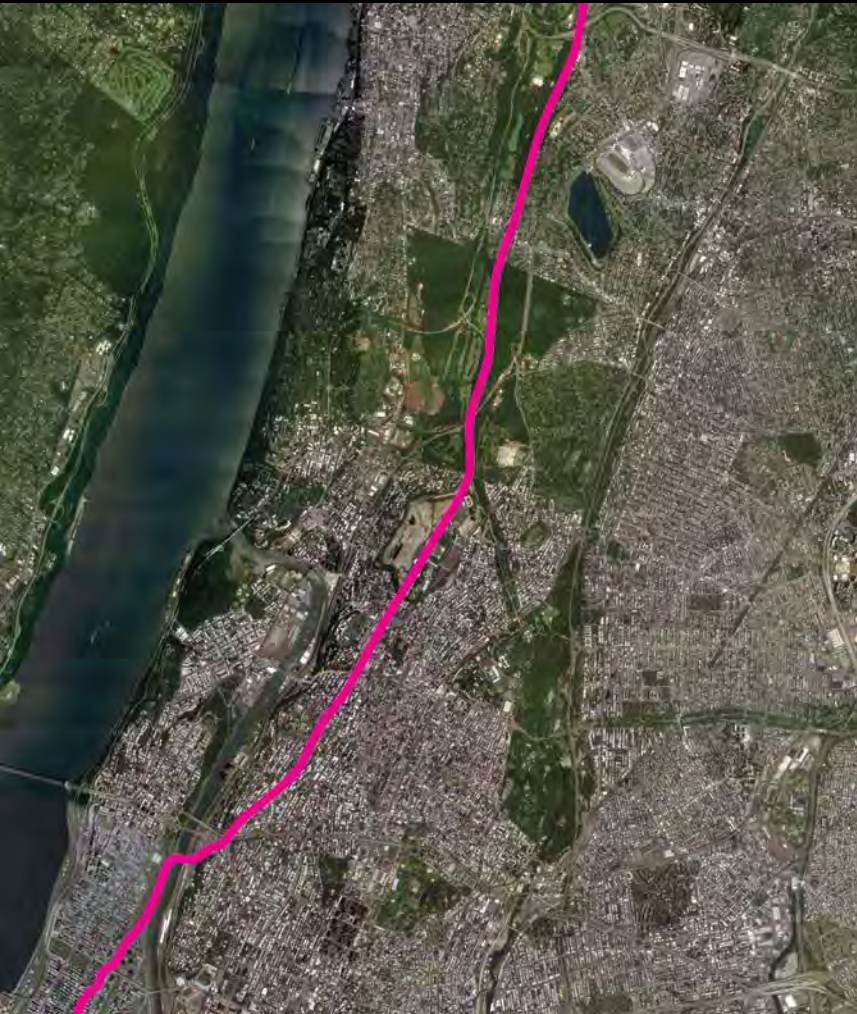

Highbridge Park

Restore and reveal the picturesque beauty of the park, provide a safe and scenic route through the middle

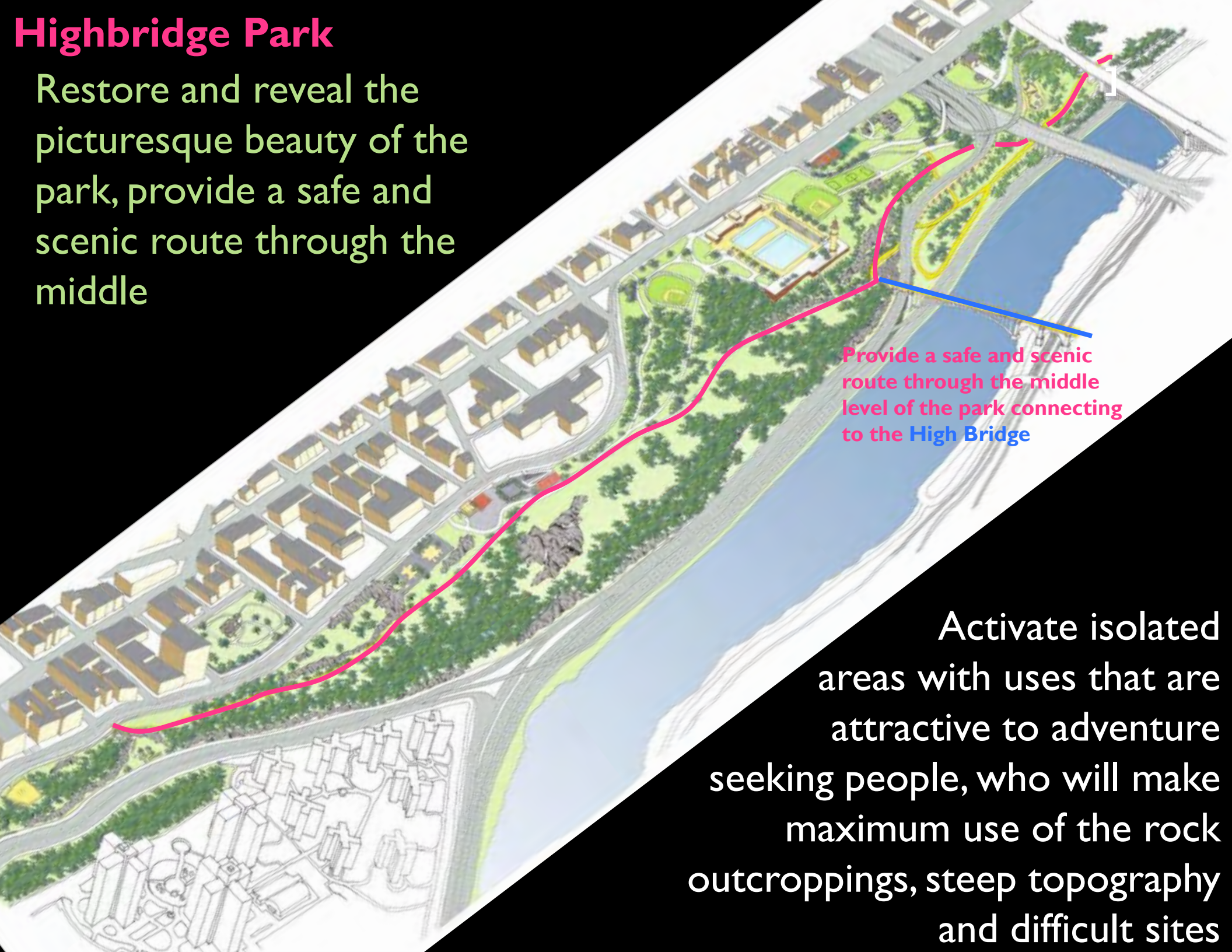

Provide a safe and scenic route through the middle level of the park connecting to the High Bridge

Activate isolated areas with uses that are attractive to adventure seeking people, who will make maximum use of the rock outcroppings, steep topography and difficult sites

Highbridge Park South

Community Concerns as reported on All Our Ideas

Each “word cloud” shows the top ten concerns people mentioned. If the type is larger, it means more people requested that item.

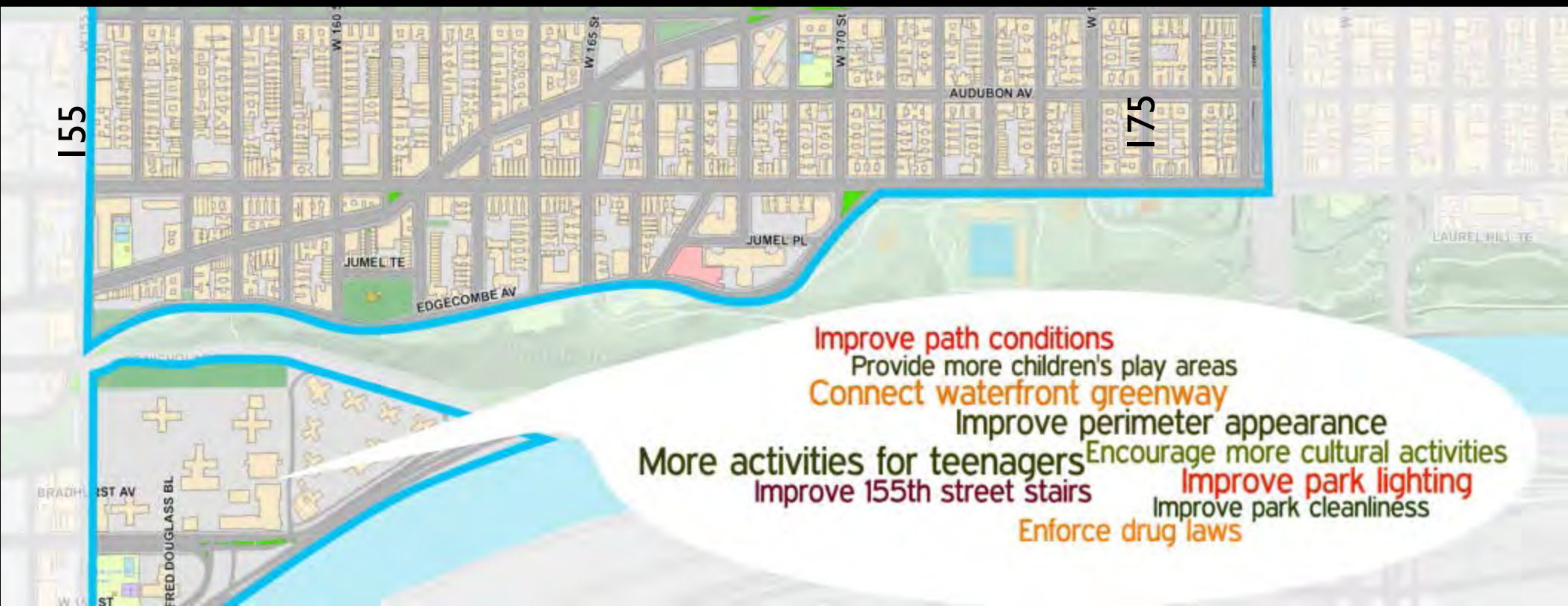

Highbridge Park South

Community Concerns as reported on All Our Ideas

Each "word cloud" shows the top ten concerns people mentioned. If the type is larger, it means the item has a high probability of being requested by other community members.



Highbridge Park North

Community Concerns as reported on All Our Ideas

Each “word cloud” shows the top ten concerns people mentioned. If the type is larger, it means the item has a high probability of being requested by other community members.

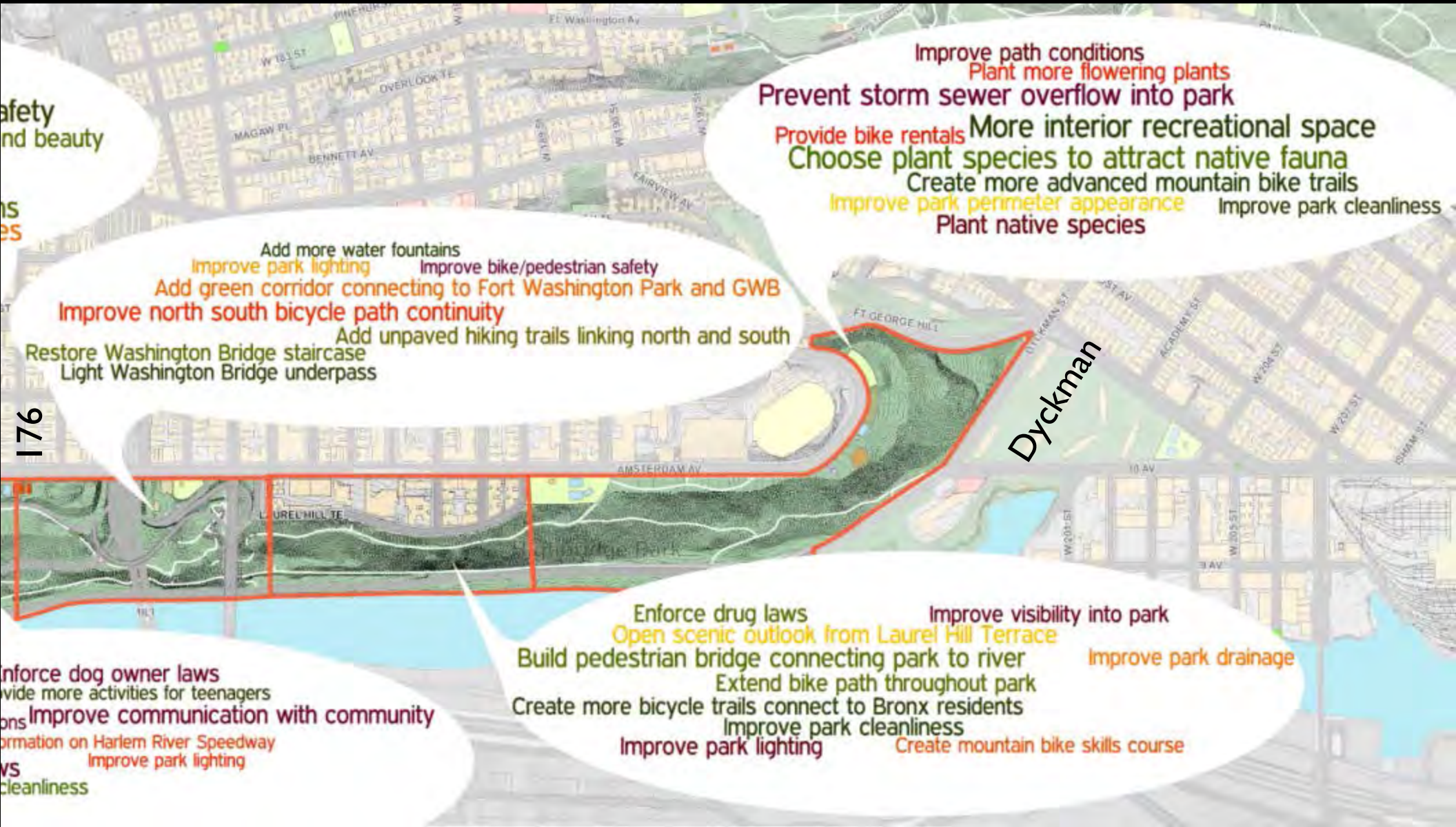

Highbridge Park

Physical Issues South

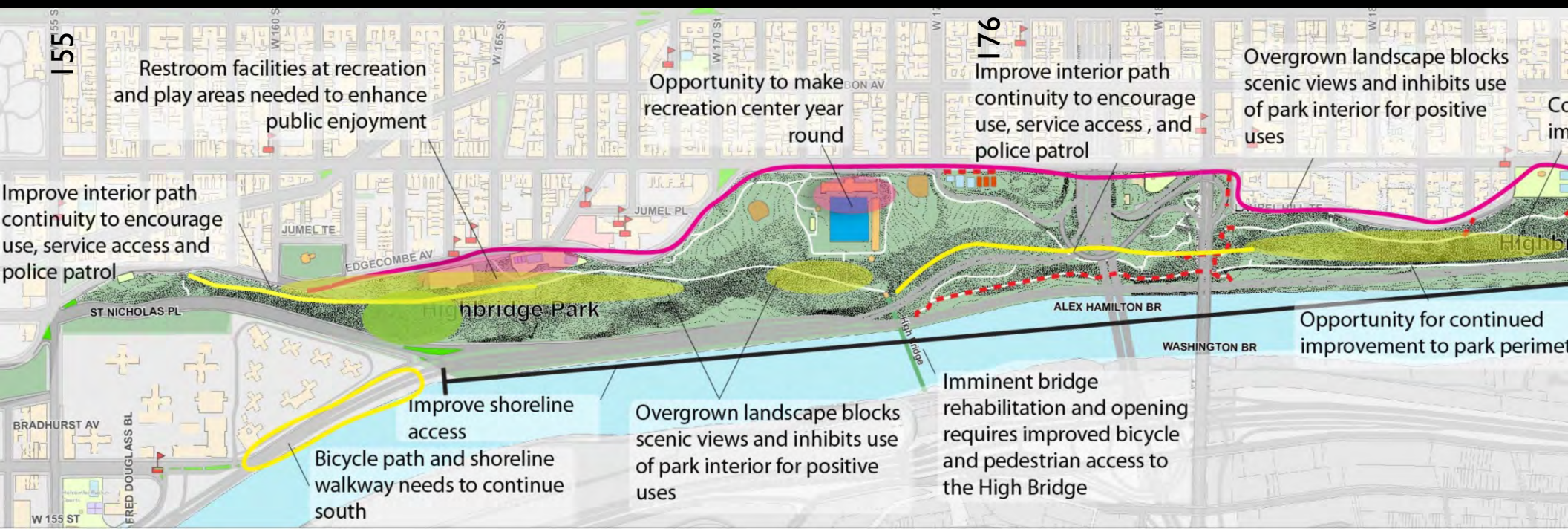

Concept Plan South



- Highbridge Park**
- Rebrand as an adventure park
 - Full court press on invasive species
 - Open sight lines to bike and pedestrian paths
 - Connect the middle level
 - Improve entire perimeter
 - Create a destination area
 - Create a neighborhood park
 - Restore the Highbridge

Highbridge Park

Physical Issues North



Concept Plan North



Highbridge Park

Provide restrooms
Add play value and exercise opportunities to playgrounds

Develop rock climbing and adventure trails

Open views from upper level park to bike route, rocks and meadows

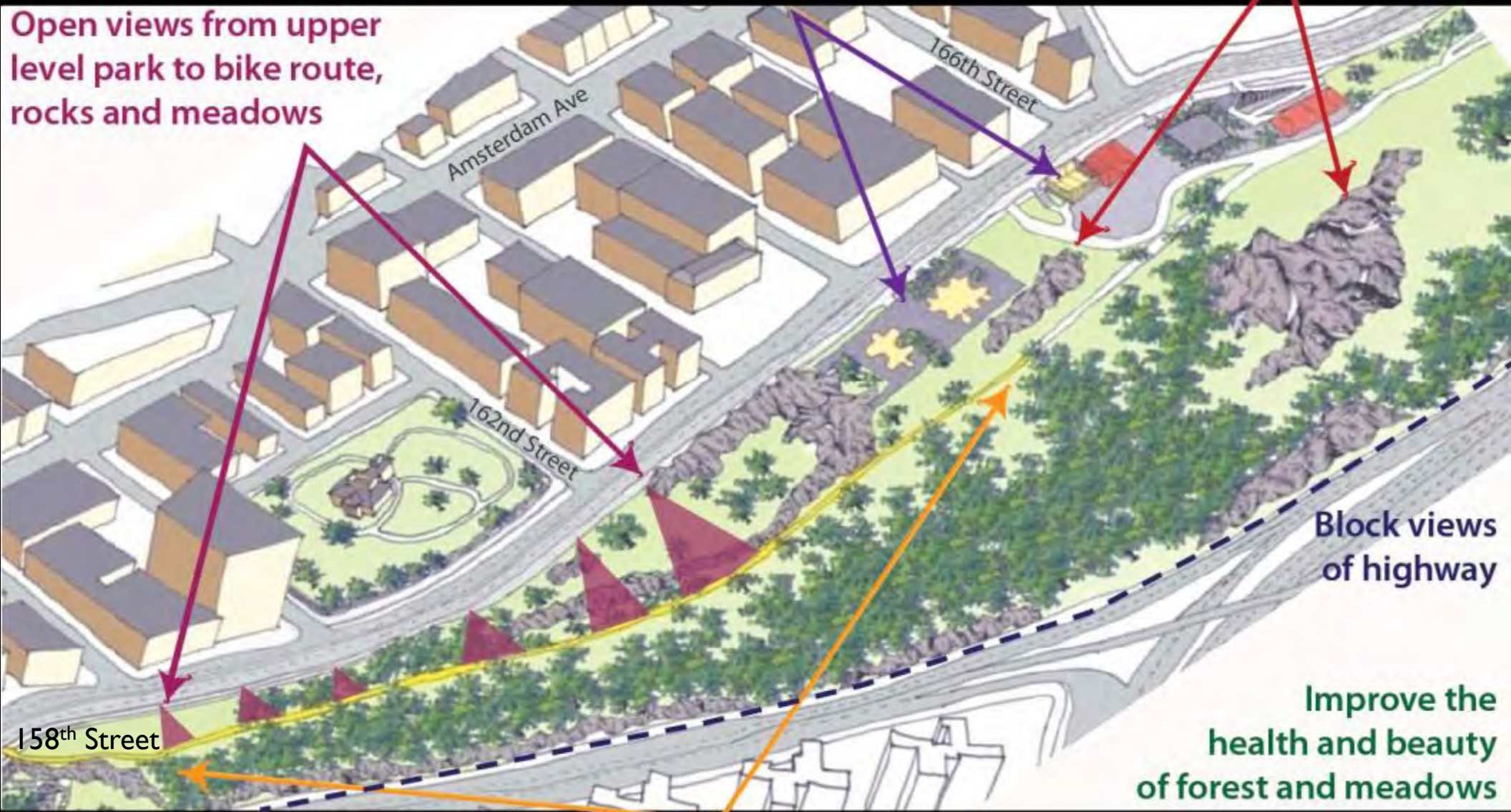

Block views of highway

Improve the health and beauty of forest and meadows

Extend and connect middle level bike path from 158th St. to Dyckman St, with police access

Highbridge Park

Open views of middle level path and scenic elements

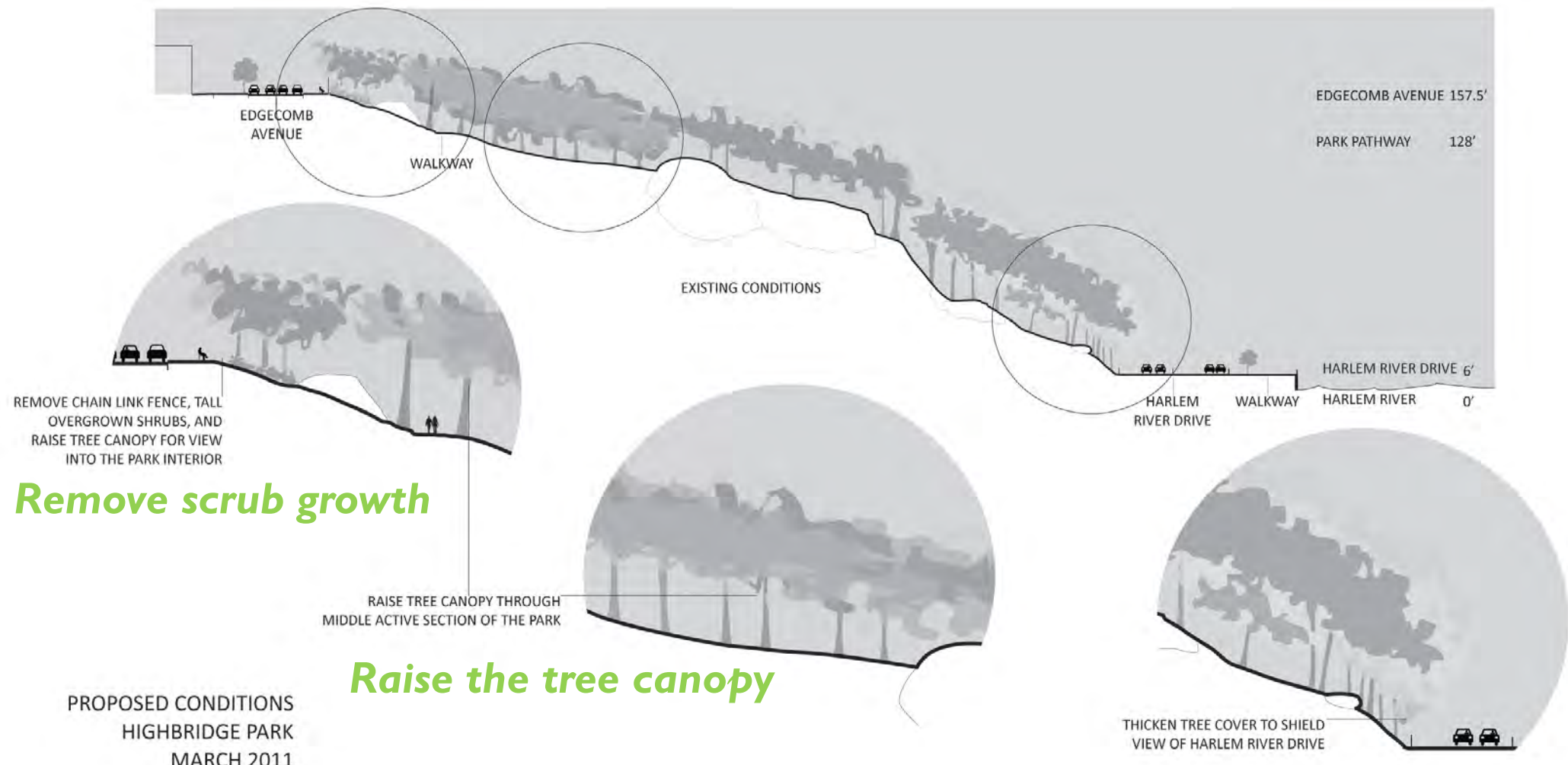

Remove scrub growth

Raise the tree canopy

Plant to block views of the highway.

PROPOSED CONDITIONS
HIGHBRIDGE PARK
MARCH 2011

Highbridge Park

Create an adventure trail through the park's middle level
Provide opportunities to learn to climb rocks and explore rugged terrain

Increase path visibility from the upper level of the park, but keep it rustic

Remove scrub growth and invasive trees around rock outcroppings

Attract day camps

Encourage family adventure



Highbridge Park

Create opportunities for adventure

Remove pipe rail and benches in front of these major rocks

Provide training and programs to encourage the use of these rocks for adventure sports

Obtain sponsors or partners for training and programs

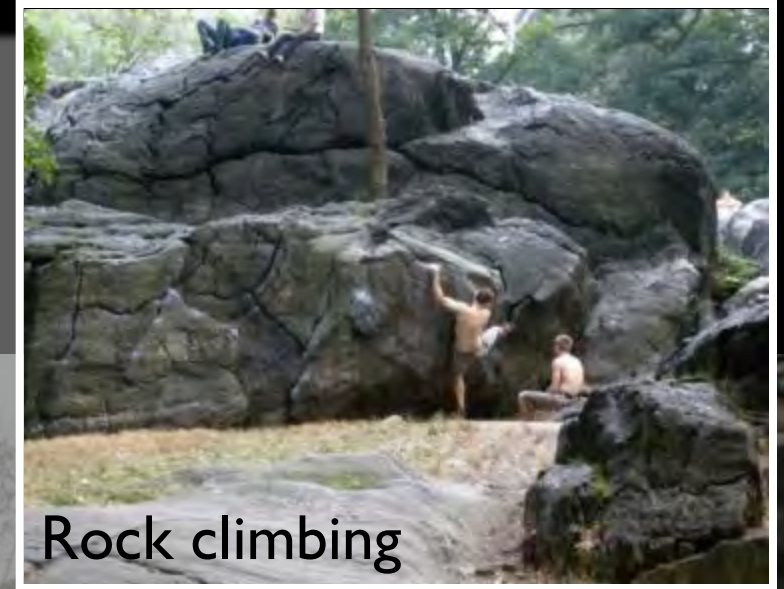

Rock climbing

Make the **Highbridge Recreation Center**

a year-round family activity and fitness attraction

NEIGHBORHOOD FAMILY FUN AND FITNESS

Skate park

Rock and water spray play

Picnic area

New Soccer Field

New Path

Terrace Café

Access to top of the tower
Local food café and catering, bike rentals

Expand the Recreation Center

Connect the bike path from the High Bridge to 182nd Street

Signalized pedestrian crossing to the River

The restored High Bridge

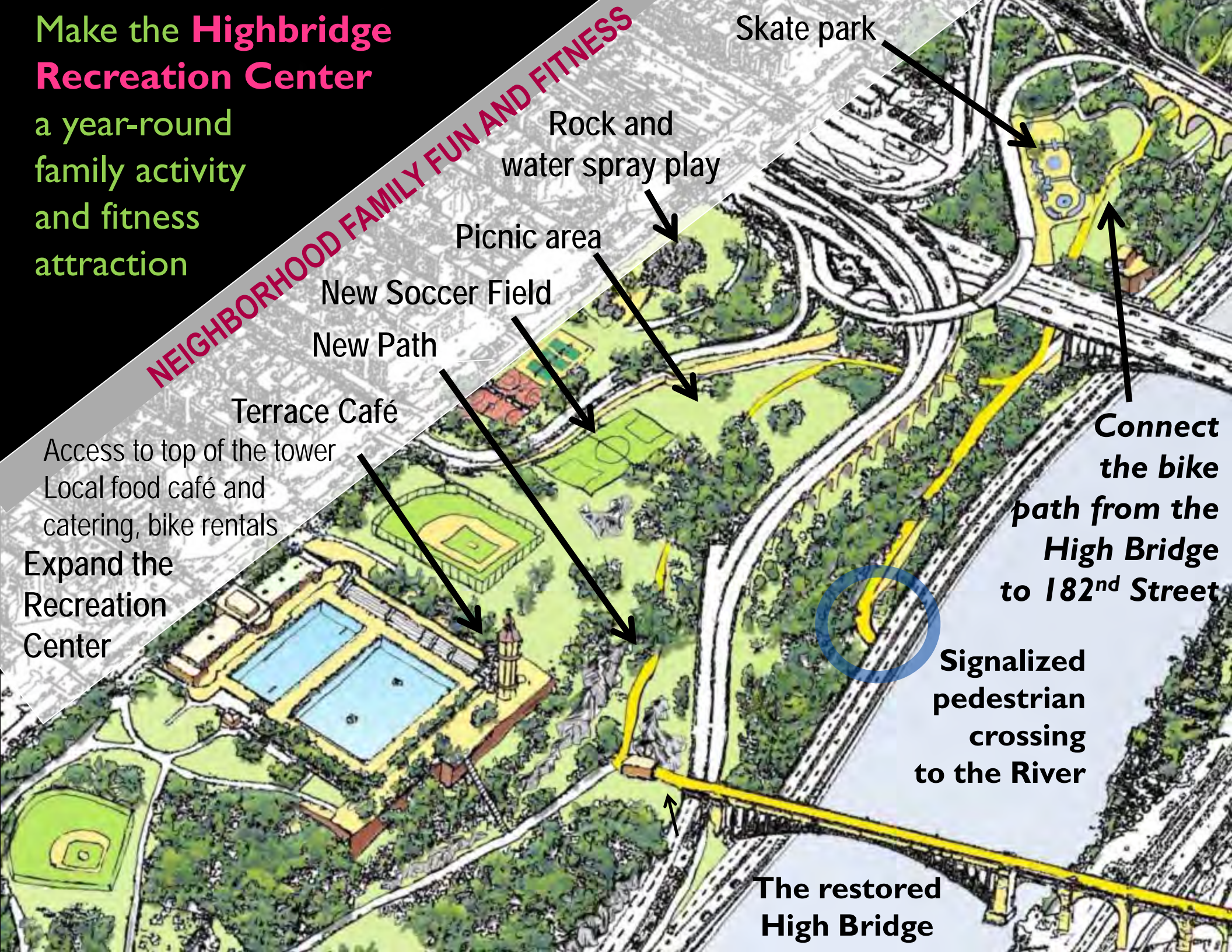

Highbridge Park Create a path through the middle level of the park

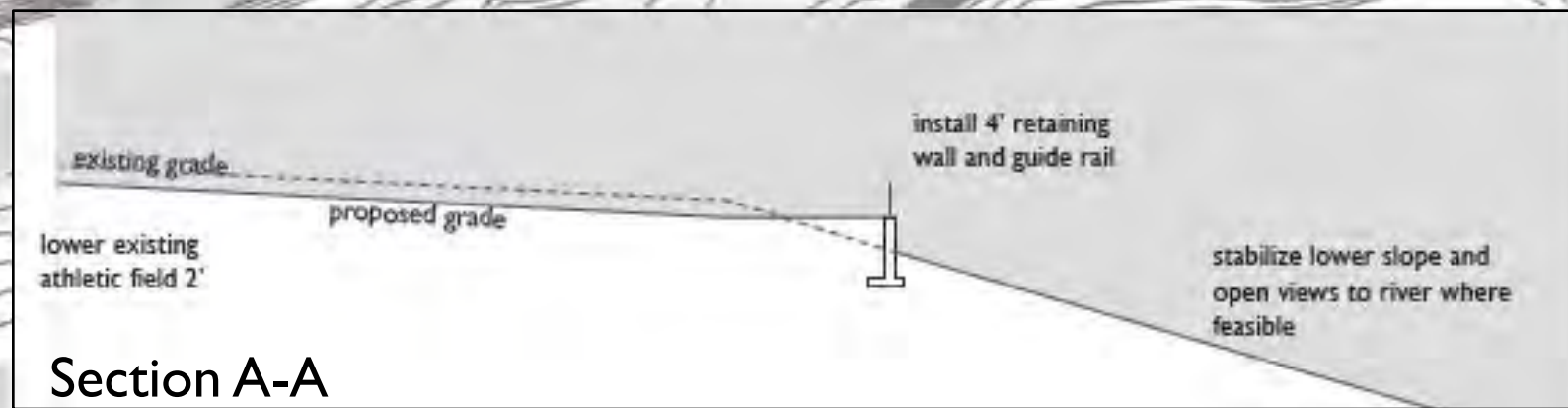

Highbridge Recreation Center

Construct external locker rooms and a new vestibule to free up internal recreation space in the recreation center during the summer

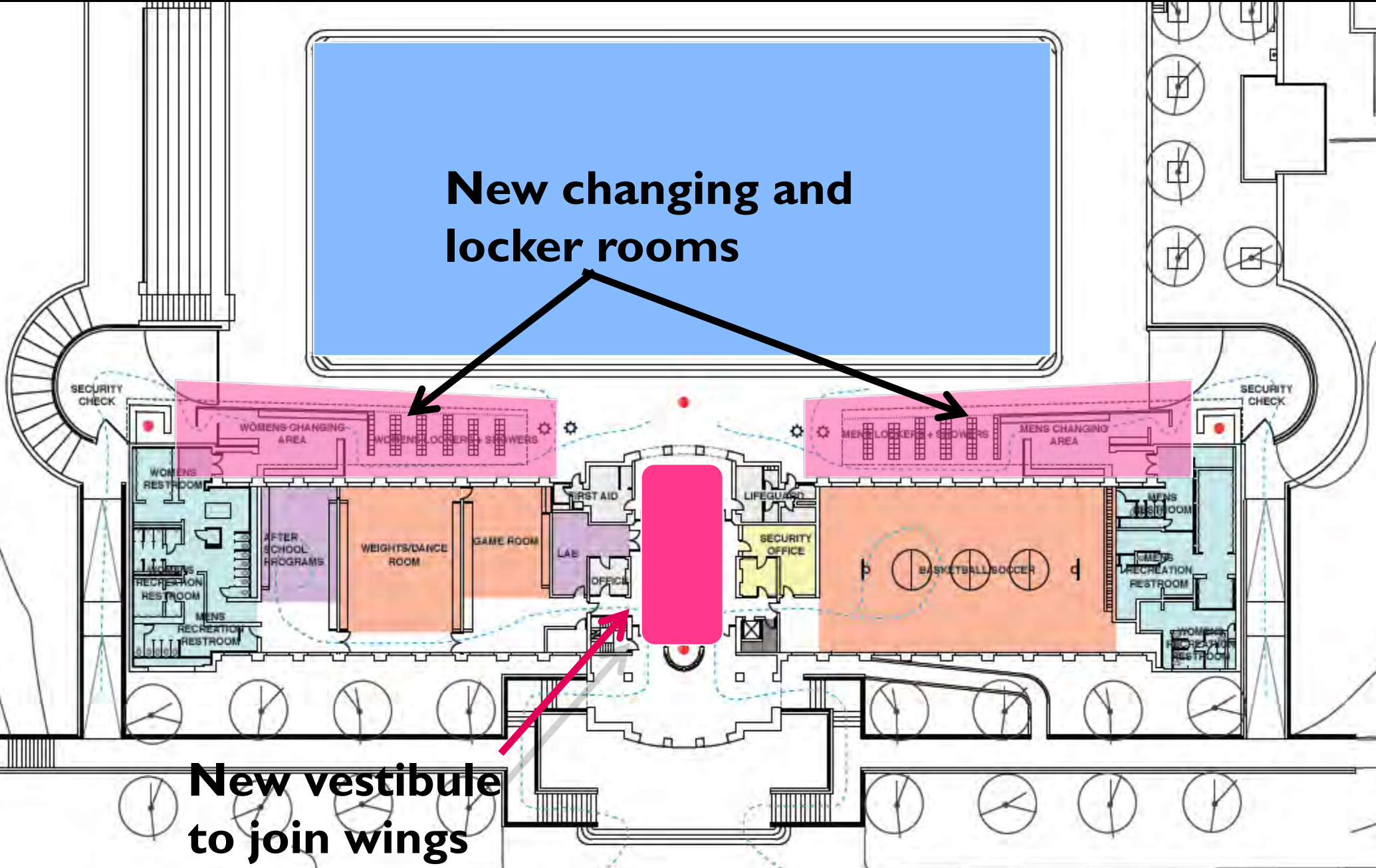

Highbridge Recreation Center

Parsons School of Design students constructed the changing pavilions in Summer 2011.

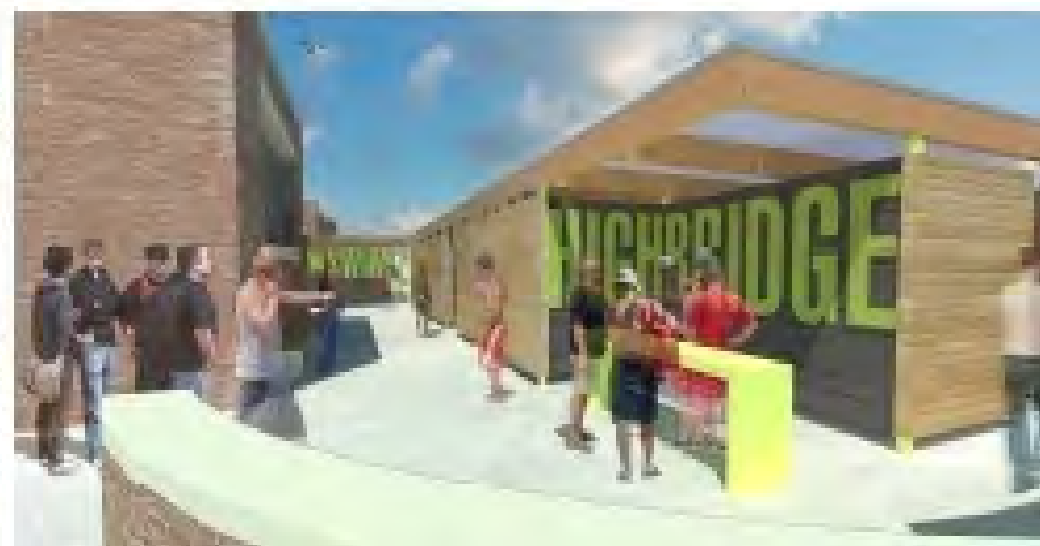

Highbridge Park

Improve landscape beauty, recreational opportunities and traffic safety

NEIGHBORHOOD FAMILY FUN AND FITNESS

Improve park character and pedestrian crossings along Dyckman St.

Construct a walkway around Sherman creek and restore the marsh

Improve mountain biking trails and pedestrian paths

Upgrade playgrounds

Provide a comfort station

Install beautiful perimeter plantings

Stop drag racing on the street

Improve park connection to street

Small boat launch and storage

Remove invasive vines and open views

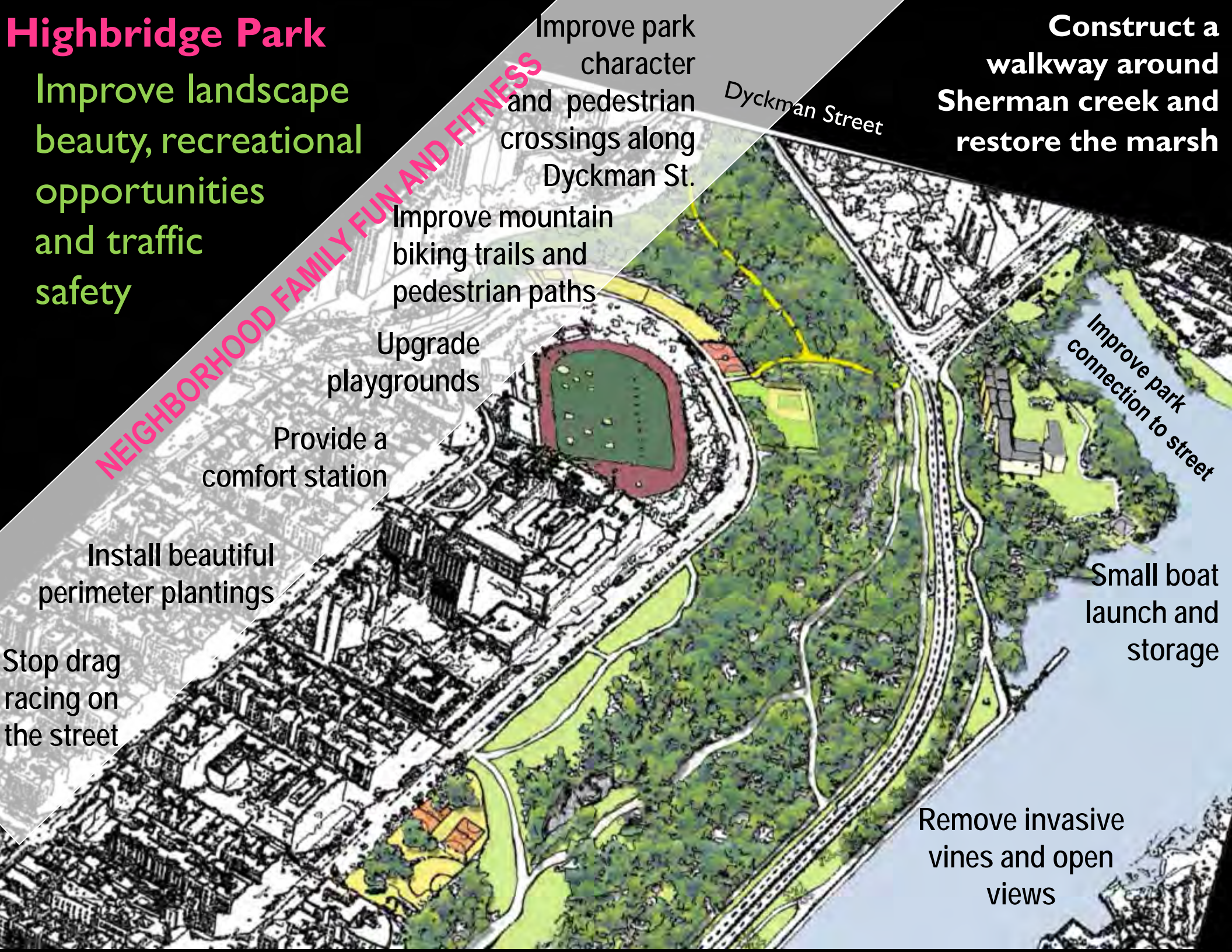

Highbridge Park

Activate isolated areas of the park with uses that are attractive to adventure-seeking people, who will make maximum use of the rock outcroppings, steep topography and difficult sites

mountain biking

skateboarding

BMX biking



Highbridge Park

Restore forest health,
ecological benefits,
and scenic beauty

Remove invasive vines and trees,
evaluate each species, its value or
threat to the ecology, and develop
a manual for treatment

Replant to establish forest balance
and maintain scenic views

Clear around rock areas
and scenic viewpoints

Establish volunteer, and after-
school ecological restoration,
educational and work programs



Highbridge Park

Remove invasive trees and vines

- Inspect important trees vulnerable to disease, such as the American Elm
- Protect sensitive areas, some are home to the Dusky Salamander, a NYC rarity, as well as garter snakes and white foot mice
- Update the entitation maps

This is a map of the plant communities prepared by the Natural Resources Group to guide restoration decisions. It considers cover type, canopy species, understory types and species and soil conditions.

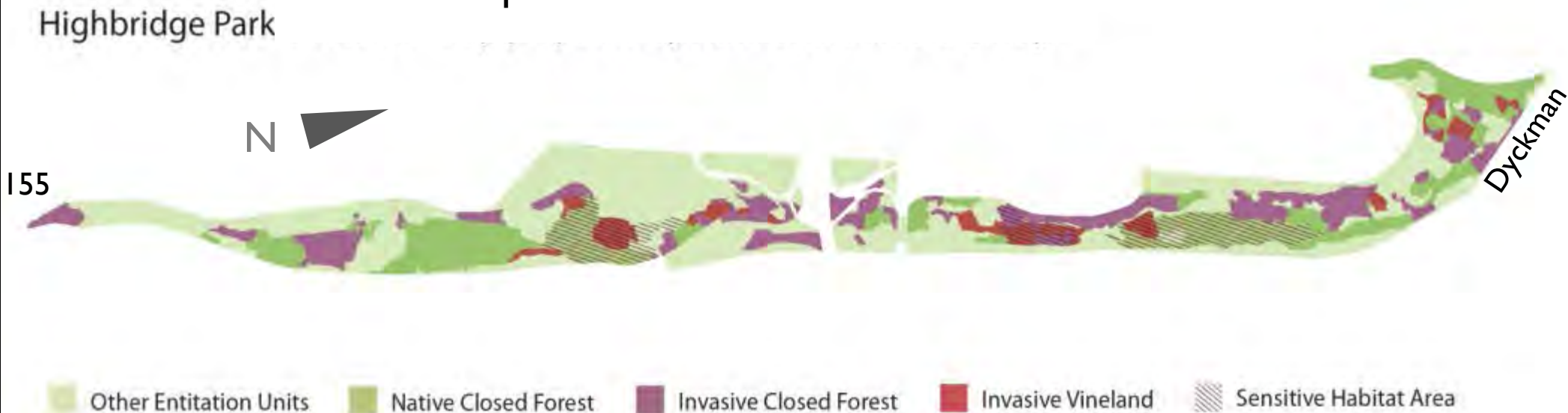

The red and purple areas require attention or the vines will continue to kill trees

Highbridge Park

Open views of middle level path and scenic elements

Remove invasive
trees and vines

Overlay maps of
invasive trees and
vines with maps of
desirable and
undesirable views, to
plan removal and
replanting

Replant view
corridors with
middle scale trees,
and meadows



Highbridge Park

Open views of middle level path and scenic elements

Remove tall fences
and scrub growth
that impedes views
where dumping has
subsided

Orient benches to
face views

Locate benches at
view points



Highbridge Park

Restore stair ensembles throughout park

Restore the stone stairs, parapets and fences

Remove improper pointing and painting from the structure

Light structures for scenic interest and pedestrian safety

Remove domestic scale planters



Highbridge Park

Redevelop the Dyckman Rest area for bike rentals and food concession

Provide attractive food vendors and an eating place

Develop a waiting area for livery car operators

Develop a mountain bike rental and concession



Highbridge Park

Improve perimeter appearance

Extend the perimeter treatment of Jackie Robinson Park

Replace the guardrail with a wooden barrier rail

Replace vandal resistant benches with a decorative metal bench

Redesign vehicular gates



Highbridge Park

Develop a rustic landscape plan that highlights the rocks and captures the water from springs and street

- Create interesting views into the landscape
- Establish new paths up to Amsterdam Avenue from Dyckman street
- Regrade to create low areas to capture water and support plantings
- Correct faulty storm sewers on Amsterdam Avenue

